

## 30° Inside Elbow with Cover

The product with code T00951030, called 30° Inside Elbow with Cover 100x300 is a component for cable routing. The 30° geometry allows the cable route to transition from the horizontal to the vertical plane, maintaining the continuity of the channel and complying with the minimum bending radius. The entire range has an internal radius of 100 mm, in accordance with the installation requirements for electrical and structured cabling systems. The body of the bend is made of 1.0 mm thick Sendzimir galvanised steel, while the cover is 0.8 mm thick. The closure system features a self-locking snap-on cover, designed to ensure quick installation and operational safety thanks to its accident prevention profile. The component is also available in hot-dip galvanised, painted and stainless steel finishes to suit specific requirements in terms of mechanical strength, corrosion and installation environment.

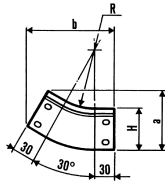

### T0 095 1030

Length: 0

#### Coatings

- 01 Galvanization (Sendzimir method) - UNI EN 10346
- 03 Hot dip galvanizing - UNI EN ISO 1461
- 11 Grey RAL 7032 - ISO9227-ISO6270-ISO2810
- 15 Blue RAL 5015 - ISO9227-ISO6270-ISO2810
- 40 Stainless steel AISI 304 - UNI EN 10088
- 41 Stainless steel AISI 316L - UNI EN 10088

Technical Characteristics	
Dimension	
W (B)	300
Weight	
[Kg]	0,85
Technical Info	
a	130
w (b)	156
R	100

Certified System
- IMQ
- EN 61537-1 ed.2007
- EN 50085-1:2005 ed EN 50085-2-1:2006
- UL file E471266
Attention: for ZT and ZM material sold/assembled in U.S.A. and Canada, please require UL mark

#### **Thickness**

- T1 095 - Component - 1,00mm
- T1 096 - Cover - 0,80mm

**\*T0 095 0507 - Dimension on demand**

#### Certifications

